

No. of Contacts	DIMENSIONS	
	A	B
4	1.27	3.00
6	2.54	4.27
8	3.81	5.54
10	5.08	6.81
12	6.35	8.08
14	7.62	9.35
16	8.89	10.62
18	10.16	11.89
20	11.43	13.16
22	12.70	14.43
24	13.97	15.70
26	15.24	16.97
28	16.51	18.24
30	17.78	19.51
32	19.05	20.78
34	20.32	22.05
36	21.59	23.32
38	22.86	24.59
40	24.13	25.86
42	25.40	27.13
44	26.67	28.40
46	27.94	29.67
48	29.21	30.94
50	30.48	32.21
52	31.75	33.48

No. of Contacts	DIMENSIONS	
	A	B
54	33.02	34.75
56	34.29	36.02
58	35.56	37.29
60	36.83	38.56
62	38.10	39.83
64	39.37	41.10
66	40.64	42.37
68	41.91	43.64
70	43.18	44.91
72	44.45	46.18
74	45.72	47.45
76	46.99	48.72
78	48.26	49.99
80	49.53	51.26
82	50.80	52.53
84	52.07	53.80
86	53.34	55.07
88	54.61	56.34
90	55.88	57.61
92	57.15	58.88
94	58.42	60.15
96	59.69	61.42
98	60.96	62.69
100	62.23	63.96

Recommended P.C.Board SMD Layout

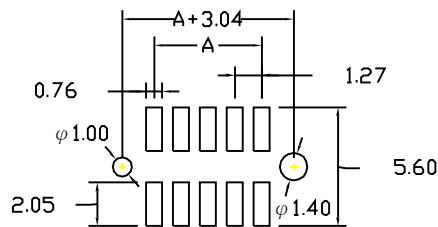

SPECIFICATIONS

Current Rating: 1 Amp
 Insulator resistance: 5000 Megohms min.
 Contacts resistance: 20 m ohms max.
 Dielectric withstanding: AC 500 V
 Operating Temperature: -40°~+105°C
 Max Processing Temp: 230° for 30 seconds
 Contact Material: Phosphor bronze
 Insulator Material: Polyester,UL 94V-0
 ©Standard: Nylon-6T

Finish: Gold plated
 ©Standard: Gold flash all over

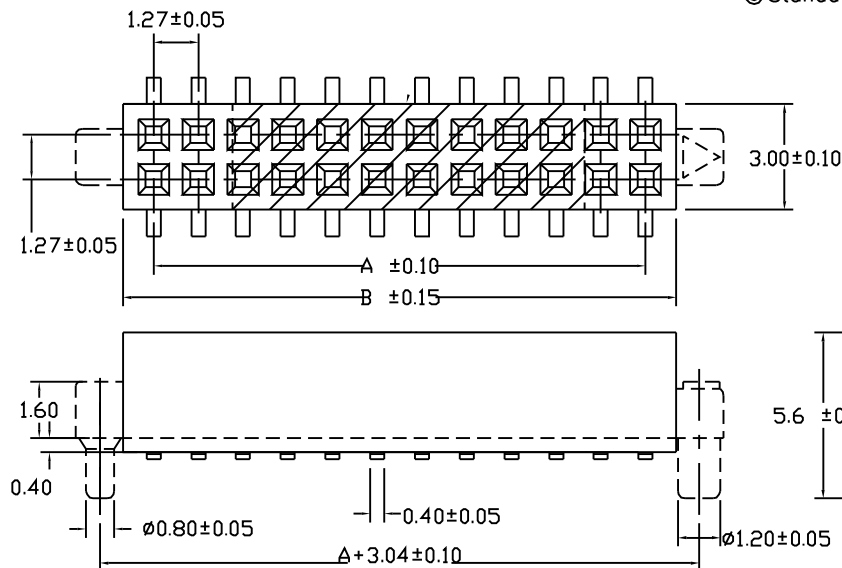

玄茂科技股份有限公司
 HSUAN MAO TECHNOLOGY CO., LTD.

UNIT

SCALE

PART NAME

MM

2:1

1.27X1.27mm FEMALE HEADER
 DUAL ROW SMT TYPE H=4.4mm

制表日: 2000/06/07

DRAWING.

APPROVED

APPD.

CKD.

TOLERANCE

PART NO.

REV.

Jane

± 0.2

C4828-XXBDXHXX

A