

BR-350S2(FS)

(2P~)

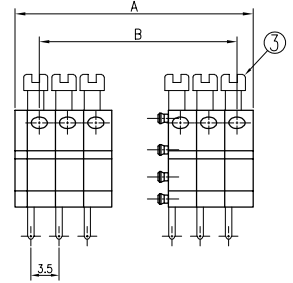
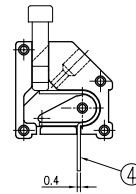
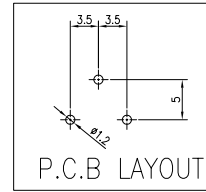
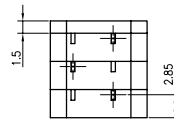
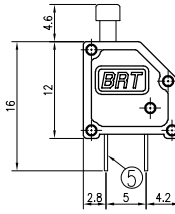
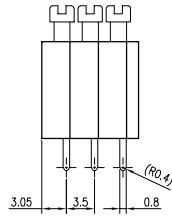
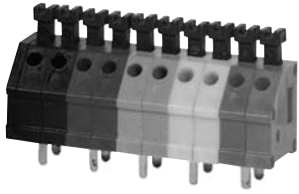

- Rating : 300V 6A
- Insulation Resistance : More Than 500MΩ DC 500V
- Withstand Voltage : AC2000V Per Minute
- Wire Size / Range : AWG24~20(Ø0.5~0.8mm)
- Maximum Acceptable Temperature : -25°C ~ +80°C
- Color : Red, Yellow, Green, Blue, Black

A-B Dimension

A.B Dimension	
A±0.5	(P x 3.5) + 1.5
B±0.5	(P - 1) x 3.5

※ 조립공차: Pin당 ±0.04mm

No	Component Part	Material	Standard	Plated	Remark
1	Frame	P.A.66	UL94V-0	-	-
2	Side Cover	P.A.66	UL94V-0	-	-
3	Push Button	P.A.66	UL94V-2	-	-
4	Terminal #1	PHOSPHOR BRONZE	C5210	Sn	-
5	Terminal #2	PHOSPHOR BRONZE	C5210	Sn	-

BR-350S2(BS)

(2P~)

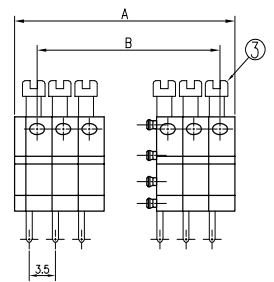
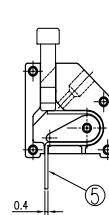
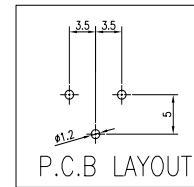
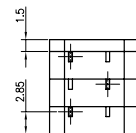
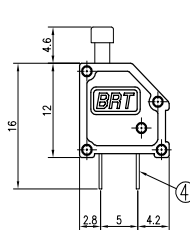
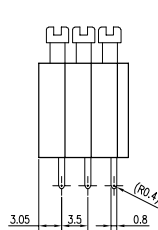
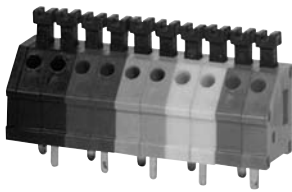

- Rating : 300V 6A
- Insulation Resistance : More Than 500MΩ DC 500V
- Withstand Voltage : AC2000V Per Minute
- Wire Size / Range : AWG24~20(Ø0.5~0.8mm)
- Maximum Acceptable Temperature : -25°C ~ +80°C
- Color : Red, Yellow, Green, Blue, Black

A-B Dimension

A.B Dimension	
A±0.5	(P x 3.5) + 1.5
B±0.5	(P - 1) x 3.5

※ 조립공차: Pin당 ±0.04mm

No	Component Part	Material	Standard	Plated	Remark
1	Frame	P.A.66	UL94V-0	-	-
2	Side Cover	P.A.66	UL94V-0	-	-
3	Push Button	P.A.66	UL94V-2	-	-
4	Terminal #1	PHOSPHOR BRONZE	C5210	Sn	-
5	Terminal #2	PHOSPHOR BRONZE	C5210	Sn	-