

대전력형 권선저항기 RWH 20W - 2000W

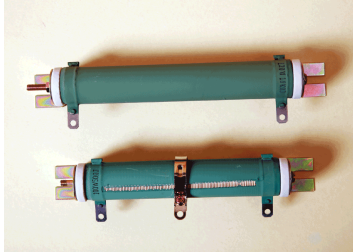

저항기의 구조는 절연강도 내압이 좋은 절연체 위에 저항선을 감은 후 불연성 도료로 도포하여 내열성이 우수하므로 높은 전력이 요구되는 산업용 기기에 적합합니다.

RWH type resistor is optimum for industrial and high-power instruments from 20W to 2KW.

The structure of RWH type resistor is that nickel-chrome wire is wound on an insulator that has good insulation, strength and withstanding voltage and, it is covered with glaze.

Derating Curve and Ordering Procedure Example

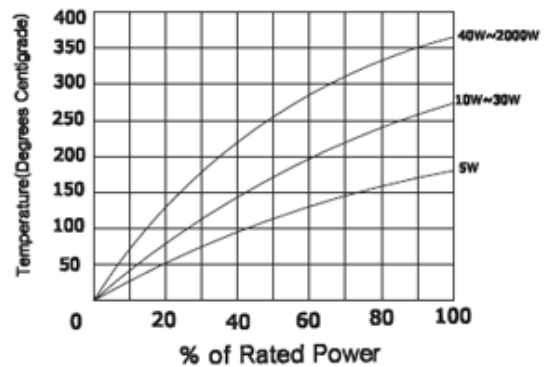
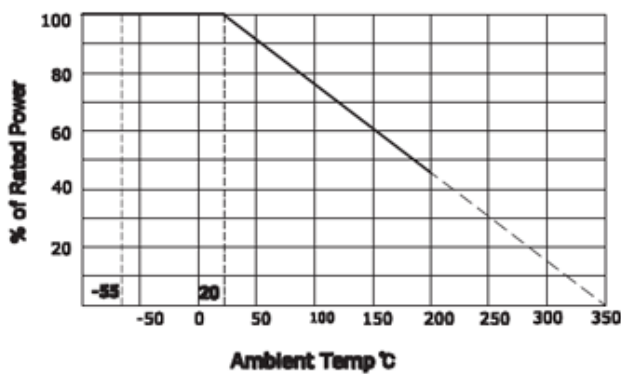

• Dimensions

RWD type

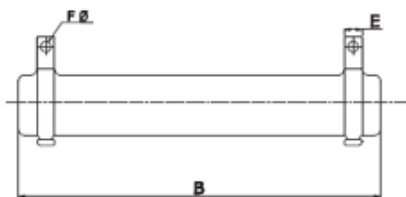

RWA type

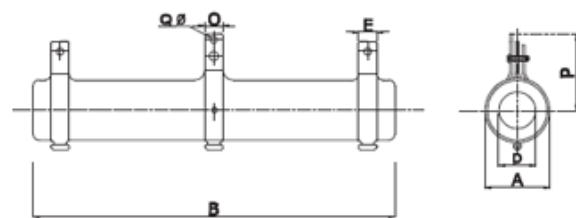

RWH type



Characteristics

Temperature Coefficient	±200ppm/°C max.	
Power Rating Load	±[1% + 0.05Ω]	[JIS-C-5202, 5-4] 350°C max.
Short Time Overload	±[2% + 0.05Ω]	1000% rated power 5 sec.
Insulation Resistance	100MΩ min. DC 500V.	
Dielectric Withstanding Voltage	RWA : AC 1500V 1 minute, RWH : AC 3000V 1 minute.	
Terminal Strength	5~20W : 4.5kgf, 20~40W : 6kgf, 60~200W:8kgf, 300~400W : 10kgf-30sec.	
Resistors Strength	5~40W:20kgf, 60~400W:30kgf-30sec.	
Vibration	Mount : RWH 1.5mm 10~55Hz/1min. X,Y,Z 2 hours each direction	
Solder ability	75% coverage MIN.	270°C, 5 sec.
Heat Resistance	350°C, 2 hours.	
Thermal Shock	±[2% + 0.05Ω]	Power rating load 30min., -55°C 15min.
Humidity (Steady state)	±[2% + 0.05Ω] , 10MΩ MIN.	40°C, 95%RH, DC100V 500 hours.
Moisture Load Life	±[2% + 0.05Ω]	0.1 x Power rating, 90min. on, 30min. off, 40°C, 95% RH, 500 hours.
Load Life	±[5% + 0.05Ω]	Power rating,, 90 min. on, 30 min. off, 500 hours.
Flame Retardant	no evidence of flaming or arcing	100~600% rated power load.

Rating & Dimensions

Type	Rated Wattage	Dimensions [mm]															
		A	B	C	D	E	F	I	J	K	L	M	N	P	Q	O	T
RWH RWD RWA	20	17	50	20	8.5	5	2.8	4.2	18	22	41	71	86	26	3.5	6	0.5
	30	17	75	20	8.5	5	2.8	4.2	18	22	41	99	110	26	3.5	6	0.5
	40	17	90	20	8.5	5	2.8	4.2	18	22	41	115	124	26	3.5	6	0.5
	50	28	75	33	14	8	4	6	26	30	62	110	133	35	4.2	8.5	1.4
	60	28	90	33	14	8	4	6	26	30	62	128	148	35	4.2	8.5	1.4
	80	28	115	33	14	8	4	6	26	30	62	150	173	35	4.2	8.5	1.4
	100	28	140	33	14	8	4	6	26	30	62	175	198	35	4.2	8.5	1.4
	120	28	165	33	14	8	4	6	26	30	62	200	221	35	4.2	8.5	1.4
	150	28	195	33	14	8	4	6	26	30	62	230	253	35	4.2	8.5	1.4
	200	28	254	33	14	8	4	6	26	30	62	290	313	35	4.2	8.5	1.4
	300	42	254	45	24	12	5.5	6.5	40	40	86	300	330	52	5	12	1.6
	400	42	330	45	24	12	5.5	6.5	40	40	86	380	407	52	5	12	1.6
	500	52	330	57	29	15	9	6.5	54	41	99	345	362	53	5	12	2.2
	600	52	330	57	29	15	9	6.5	54	41	99	375	392	53	5	12	2.2
	800	65	330	65	46	20	10	10	65	59	126	385	404	72	10	20	2.2
	1000	77	330	71	47	20	10	10	75	63	130	388	408	80	10	20	2.2
	1200	77	330	71	47	20	10	10	75	63	130	388	408	80	10	20	2.2
1500	77	420	71	47	20	10	10	75	63	130	478	498	80	10	20	2.2	
2000	77	500	71	47	20	10	10	75	63	130	558	578	80	10	20	2.2	

UNI RESISTOR (UNIKOR)