

$$A = 1.27 * (\text{NO of Space})$$

$$B = A + 1.27$$

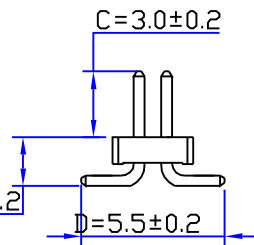
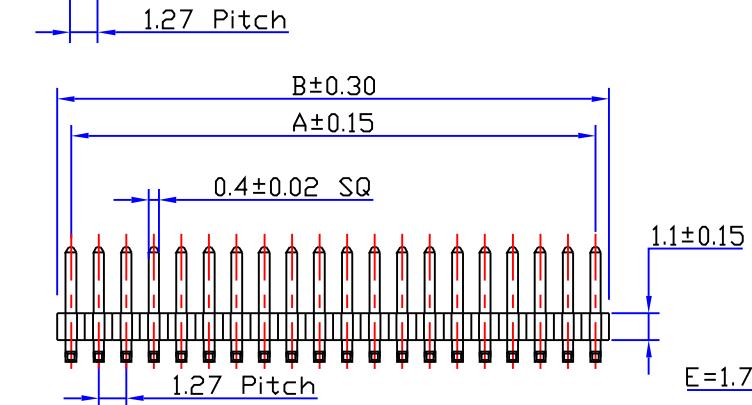

SPECIFICATIONS

Current Rating: 1 Amps
 Dielectric Withstanding: AC 500V
 Operating Temperature: -40°C to +105°C
 Max Processing Temp: 230° for 30~60 seconds
 (260° for 10 seconds)

MATERIAL&FINISH

Contact: Brass
 Insulator Material: Nylon 6T
 Color: Black
 Finish: Gold Flash Plated Over Nickel

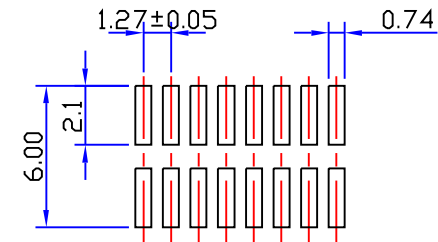

P.C.Board Layout

ORDER INFORMATION

Contact No.	Row Type	Contact Type	Contact Plating	Pin Length (mm)	Others
C1281 — <input type="text" value="A0"/>	<input type="text" value="B"/>	<input type="text" value="D"/>	<input type="text" value="G"/>	<input type="text" value="A"/> <input type="text" value="T"/>	<input type="text" value="0"/>
04(2X2)~100(2X50) ※ 100P=A0	B: Dual Row	D: SMT	T: Tin S: Selective Gold G: Gold Flash A: Gold 5U* B: Gold 10U* C: Gold 15U* D: Gold 30U*	AT(S.M.T.) C=3.00mm D=5.50mm E=1.70mm	0: No Option T: Tube Packing R: Reel Packing P: PAD+Tube Packing Q: PAD+Reel Packing

玄茂科技股份有限公司
HSUAN MAO TECHNOLOGY CO., LTD.

UNIT

SCALE

PART NAME

MM

3:1

1.27X1.27mm PIN HEADER H=1.1mm
 SMT DUAL ROW (C=3.0 D=5.5 E=1.7)

制表日:2003/08/19

DRAWING.

APPROVED

APPD.

CKD.

TOLERANCE

PART NO.

REV.

Jane

± 0.2

C1281-XXBDXAT0

A