

1 2 3 4 5 6 7 8

A

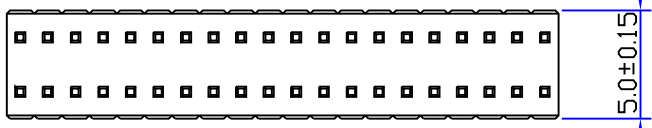

$A = 1.27 * (\text{NO of Space})$   
 $B = A + 1.27$

**SPECIFICATIONS**

Current Rating: 1 Amps  
 Dielectric Withstanding: AC 500V  
 Operating Temperature: -40°C to +105°C  
 Max Processing Temp: 230° for 30~60 seconds  
 (260° for 10 seconds)

**MATERIAL&FINISH**

Contact: Brass  
 Insulator Material: Nylon 6T  
 Color: Black  
 Finish: Gold Flash Plated Over Nickel

B

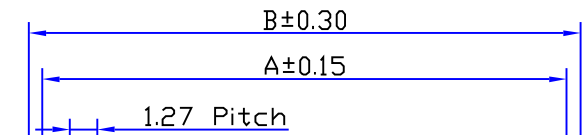

C

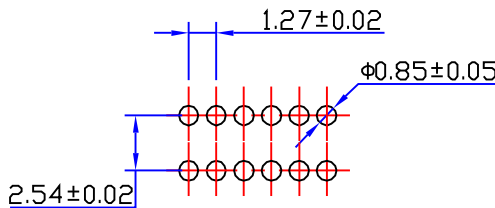
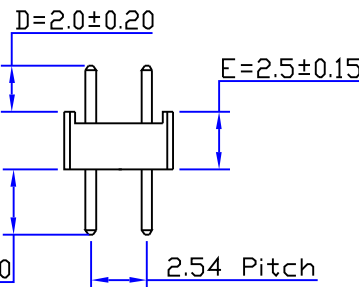
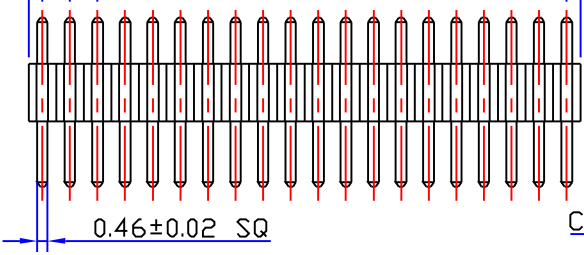

P.C.Board Layout

D

E

**ORDER INFORMATION**

Contact No.	Row Type	Contact Type	Contact Plating	Pin Length (mm)	Others
C1270 — <input type="text" value="A0"/>	<input type="text" value="B"/>	<input type="text" value="S"/>	<input type="text" value="G"/>	<input type="text" value="A"/> <input type="text" value="S"/>	<input type="text" value="0"/>
04(2X2)~100(2X50) * 100P=A0	B: Dual Row	S: Straight	T: Tin S: Selective Gold G: Gold Flash A: Gold 5U" B: Gold 10U" C: Gold 15U" D: Gold 30U"	AS(180°) { C=2.85mm D=2.00mm E=2.50mm	0: No Option T: Tube Packing R: Reel Packing P: PAD+Tube Packing Q: PAD+Reel Packing

F

G

**玄茂科技股份有限公司**  
**HSUAN MAO TECHNOLOGY CO., LTD.**

UNIT		SCALE	PART NAME	
MM		3:1	1.27X2.54mm PIN HEADER H=2.5mm 180° DUAL ROW (C=2.85 D=2.0 E=2.5)	
APPD.	CKD.	TOLERANCE	PART NO.	REV.
		± 0.2	C1270-XXBSXAS0	A

H

制表日:2003/08/19

DRAWING. APPROVED  
*Jane*

1 2 3 4 5 6 7 8